

FUNCTION ROOMS	DIMENSIONS				BANQUET			MEETING		
	TOTAL sq. ft.	LENGTH feet	WIDTH feet	CEILING HT feet	BANQUET	THEATER	CLASSROOM	CONFERENCE HOLLOW SQUARE	RECEPTION	U-SHAPE*
Ballroom Level										
Grand Ballroom**	6,016	64	94	11.1	500	500	325	-	700	-
I	2,048	64	32	13.1	130	160	100	60	200	50
II	1,920	64	30	13.1	110	150	90	60	200	50
III	2,048	64	32	13.1	130	160	100	60	200	50
Alpine Ballroom	2,560	80	32	18.4	180	225	150	75	250	70
I	1,024	32	32	18.4	50	65	30	30	80	28
II	1,536	48	32	18.4	110	150	75	50	150	45
St. Moritz	270	18	15	8.5	20	24	12	12	25	-
Grindelwald	270	18	15	8.5	20	24	12	12	25	-
Zermatt	270	18	15	8.5	20	24	12	12	25	-
Gstaad	270	18	15	8.5	20	24	12	12	25	-
43rd Floor										
Edelweiss										
Penthouse	3,144	-	-	9	240	250	-	-	350	-
I	1,470	70	21	9	80	100	30	30	100	28
II	1,674	62	27	9	110	125	60	50	150	46
Swiss Grand Ballroom	14,248	137	104	17'	1080	1500	702		1700	
Swiss Grand BR 1	4,680	104	45	17'	360	600	250		550	100
Swiss Grand BR 2	4,680	104	45	17'	360	600	250		550	100
Swiss Grand BR 3	4,680	104	45	17'	360	600	250		550	100
Swiss Grand BR 1A	1,530	34	45	17'	120	160	84	36	180	40
Swiss Grand BR 1B	1,530	34	45	17'	120	160	84	36	180	40
Swiss Grand BR 1C	1,530	34	45	17'	120	160	84	36	180	40
Swiss Grand BR 3A	1,564	34	46	17'	120	160	84	36	184	40
Swiss Grand BR 3B	1,564	34	46	17'	120	160	84	36	184	40
Swiss Grand BR 3C	1,564	34	46	17'	120	160	84	36	184	40
Swiss Grand BR 1 & 2	9,360	104	90	17'	720	1000	500		1100	
Swiss Grand BR 2 & 3	9,464	104	91	17'	720	1000	500		1120	
Swiss Grand BR 1 A & B	3,060	68	45	17'	240	360	160	62	360	70
Swiss Grand BR 1 B & C	3,060	68	45	17'	240	360	160	62	360	70
Swiss Grand BR 3 A & B	3,12	68	46	17'	240	360	160	62	368	70
Swiss Grand BR 3 B & C	3,128	68	46	17'	240	360	160	62	368	70
Zurich Ballroom	5,775	105	55	15'	450	550	312	100	700	105
Zurich Ballroom 1	1,430	55	26	15'	100	150	70	48	180	45
Zurich Ballroom 2	1,430	55	26	15'	100	150	70	48	180	45
Zurich Ballroom 3	1,430	55	26	15'	100	150	70	48	180	45
Zurich Ballroom 4	1,430	55	26	15'	100	150	70	48	180	45
Zurich Ballroom 1 & 2	2,860	55	52	15'	250	340	145		350	54
Zurich Ballroom 2 & 3	2,860	55	52	15'	250	340	145		350	54
Zurich Ballroom 3 & 4	2,860	55	52	15'	250	340	145		350	54
Zurich Ballroom 1,2,3	4,290	55	78	15'	350	500	230		500	85
Zurich Ballroom 2,3,4	4,290	55	78	15'	350	500	230		500	85
Montreux	3,000	75	40	15'	280	325	150	72	353	75
Montreux 1	1,000	40	25	15'	60	100	45	36	120	39
Montreux 2	1,000	40	25	15'	60	100	45	36	120	39
Montreux 3	1,000	40	25	15'	60	100	45	36	120	39
Montreux 1 & 2	2,000	40	50	15'	160	240	105	48	235	53
Montreux 2 & 3	2,000	40	50	15'	160	240	105	48	235	53
St. Gallen	3,000	75	40	15'	280	325	150	72	353	75
St. Gallen 1	1,000	40	25	15'	60	100	45	36	120	39
St. Gallen 2	1,000	40	25	15'	60	100	45	36	120	39
St. Gallen 3	1,000	40	25	15'	60	100	45	36	120	39
St. Gallen 1 & 2	2,000	40	50	15'	160	240	105	48	235	53
St. Gallen 2 & 3	2,000	40	50	15'	160	240	105	48	235	53
3rd Floor Suites										
Engelberg	810	45	18	9'	50	60	30	30	70	28
Vevey	810	45	18	9'	50	60	30	30	70	28
Klosters	600	30	20	9'	30	25	15/12	12	40	12
Pontresina	580	29	20	9'	30	25	15	12	40	12
Fribourg	510	30	17	9'	30	40	20	20	40	18
Verbier	510	30	17	9'	30	40	20	20	40	18
Appenzell	476	28	17	9'	30	25	15	12	40	12
4th Floor Suites										
Davos	810	45	18	9'	50	60	30	30	70	28
Neuchatel	810	45	18	9'	50	60	30	30	70	28
Crans-Montana	600	30	20	9'	30	25	15	12	40	12
Villars	580	29	20	9'	30	25	15	12	40	12
Interlaken	510	30	17	9'	30	40	20	20	40	18
Zug	510	30	17	9'	30	40	20	20	40	18
Wengen	476	28	17	9'	30	25	15	12	40	12

* Based on 3 ppl per 6'

** Maximum seating capacity is 500; however, if an event is a reception, the maximum capacity is 700 for the Ballroom only.

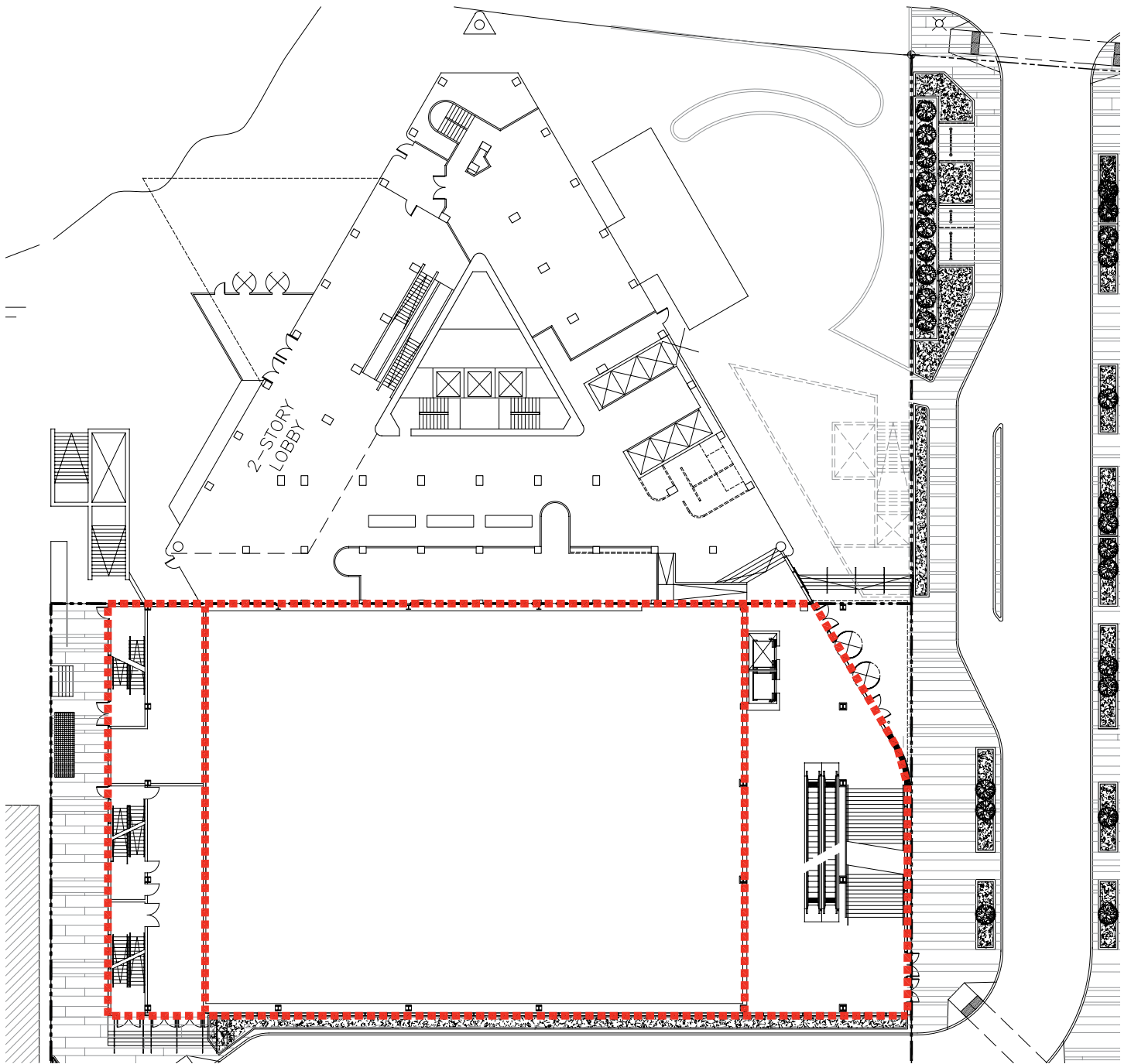

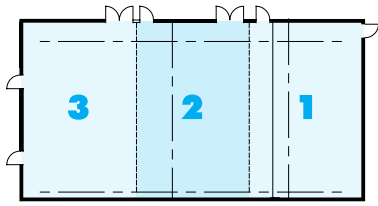

MONTREUX

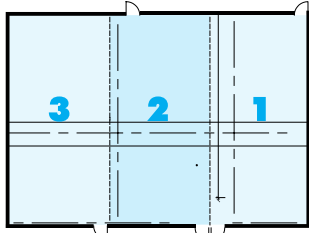

ST. GALLEN

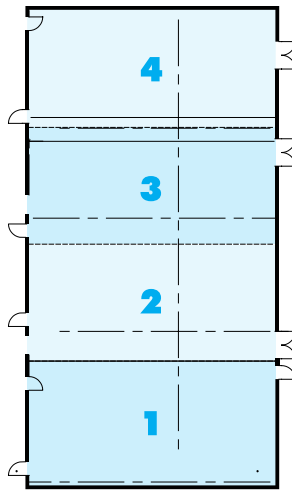

ZURICH BALLROOM

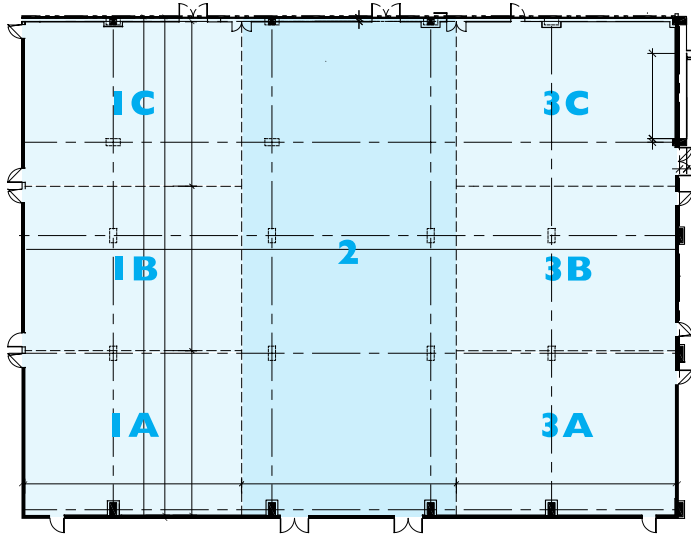

SWISS GRAND BALLROOM

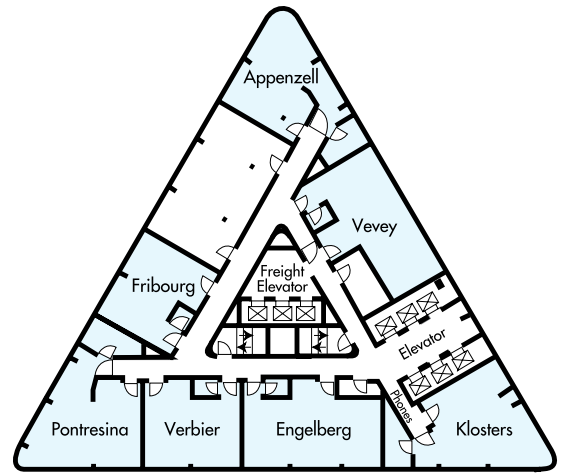

3RD FLOOR

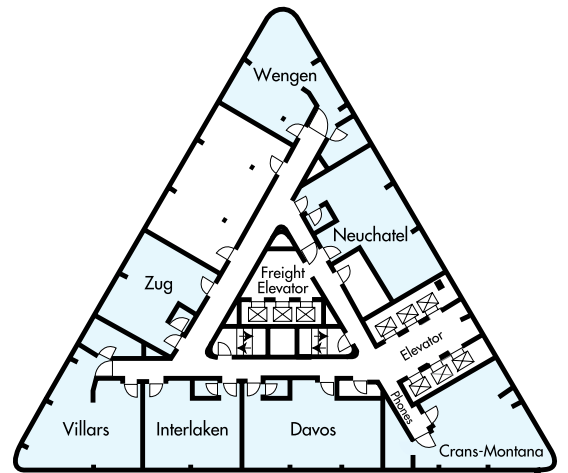

4TH FLOOR

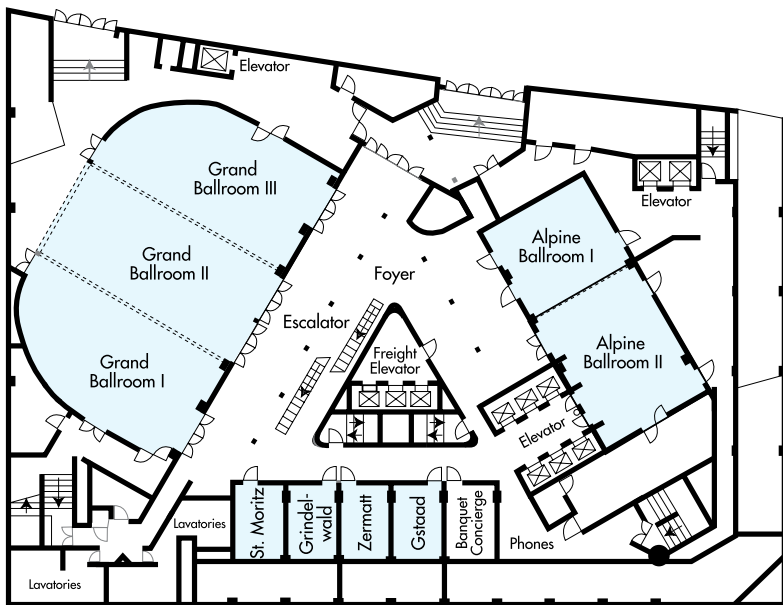

BALLROOM LEVEL

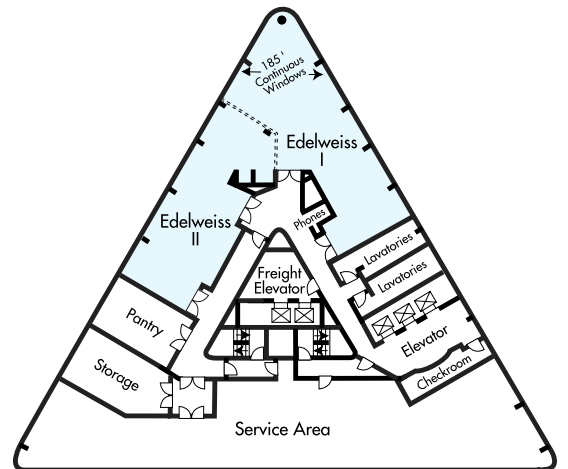

43RD FLOOR